

HIKVISION EUROPE

Monthly External Technical Newsletter

CONTENTS

New Firmware / Software Release
Product How to
Product Q&A

October 2025

Main Contents

01 New Firmware / Software Release

- Channel CCTV

02 Product How to

- How to Setup Wireless Bridge on Hik-Partner Pro

03 Product Q&A

- What is the difference between Auto/Triggered by Video in Day Night Switching?
- Does the 4G module of the solar-powered camera support IPV6?
- What is the sticker material on the tamper-free packaging of 311328682 DS-2CD2687G3-LIZS2UY/SRB?
-

Editor-in-Chief: John Wu | Editor: David Jin | Executive Editor: Effie Ding



Contributions and feedback

An informative and inspiring newsletter needs your continual contributions and feedback. Please feel free to submit your comments to product.eu@hikvision.com.

01 New Firmware / Software Release

Channel CCTV

NVR	DS-7616NXI-I2/Vpro	V5.05.361 build 202509029	<ul style="list-style-type: none"> Add to support the following AcuSeek languages in Europe: Dutch/ Romanian/ Czech/ Swedish/ Croatian/ Latvian/ Ukrainian/ Hungarian/ Danish/ Brazilian Portuguese
	DS-7716NI-M8	V5.04.070_build250828	<ul style="list-style-type: none"> Support to add 4G & non-4G Hikvision IP camera (non-solar models) whose support ISUP5.0 protocol; Support configure arming/disarming schedules on HC, auto arm/silent arm/disarm each channel at specific time (hour:mintue) ; Support to add high frame rate IP camera via Hikvision protocol; Support to add multi-chnnel IP cameras via POE, you can add the other channels under Video Device menu; Support to attach 3 images for perimeter protection when choosing to send alarm email.
	DS-7608NXI-I2/S (E)	V5.04.070_build250828	<ul style="list-style-type: none"> Support to add high frame rate IP camera via Hikvision protocol; Support to add multi-chnnel IP cameras via POE, you can add the other channels under Video Device menu; Support to attach 3 images for perimeter protection when choosing to send alarm email.
DVR	iDS-7204HQHI-M1/XT	V4.83.611 build 250708	<ul style="list-style-type: none"> Fix known issues
IPC	DS-2CD1021G2-IU DS-2CD1027G2-L	V5.8.30 build 250714	<ul style="list-style-type: none"> Support HTTP and HTTPS switches, both default ON. Support RTSP switch, default ON. Support rtsp over https. Only for WiFi cameras: support SDK over TLS, default ON.

Note: Get the firmware via searching specific models in Hikvision official websites (Global or EU).

02 Product How to

How to Setup Wireless Bridge on Hik-Partner Pro

Preparation

Devices & Firmware

Model	SAP	Firmware requested
DS-3WF0EC-5ACT(B)	317200386	V1.2.0_250120 and above
DS-3WF0EC-5ACT	317200219	V1.2.0_250120 and above
DS-3WF0EC-2NT	317200439	V1.2.0_250120 and above
DS-3WF0BC-2NT	317200216	V1.2.0_250120 and above
DS-3WF0BC-2NT(B)	317200367	Not support HPP
DS-3WF03C-5AC/O V2	317200146	Need to upgrade Intermediate firmware first, then upgrade to V1.2.0_250120 and above
DS-3WF03C-5AC/O V3	317200376	V1.2.0_250120 and above
DS-3WF02-5AC/D	317200389	V1.2.0_250120 and above
DS-3WF02C-5AC/O V2	317200145	Need to upgrade Intermediate firmware first, then upgrade to V1.2.0_250120 and above
DS-3WF02C-5AC/O V3	317200375	V1.2.0_250120 and above
DS-3WF0FC-2N/O	317200206	V1.2.0_250120 and above
DS-3WF0FA-2N/O	317200207	V1.2.0_250120 and above
DS-3WF3000-EI-5AC/P	317200483	V1.2.0_250120 and above
DS-3WF3000S-EI-5AC/P	317200486	V1.2.0_250120 and above
DS-3WF1000-EI-2N	317200474	V1.2.0_250120 and above
DS-3WF1000S-EI-2N	317200477	V1.2.0_250120 and above
DS-3WF0FA-5AC/O	317200314	V1.2.0_250120 and above

Hik-Partner Pro Version 2.12.0 Build 250210.15 or above.

Connection

Ensure the Internet connection is normal, connect all bridges into this network using network cables, and then use your phone to connect this Wi-Fi from the wireless router.

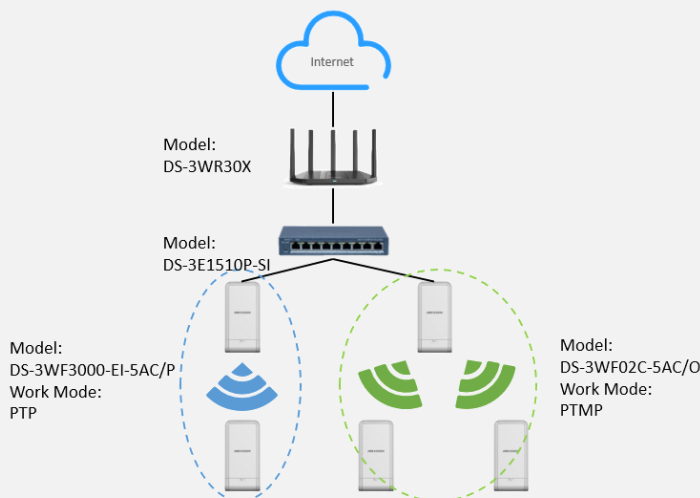

Setup

- Activate

Inactivated devices will pop-up on home page or can be searched on SADP tools.

02 Product How to

How to Setup Wireless Bridge on Hik-Partner Pro

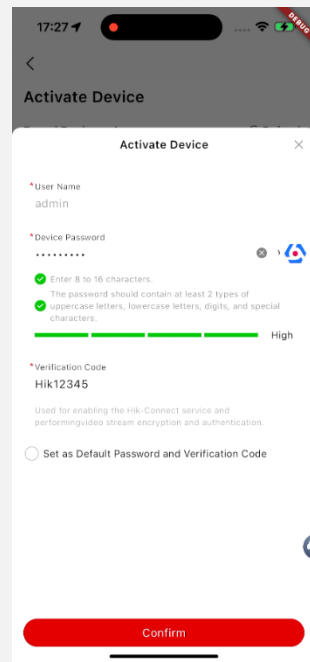
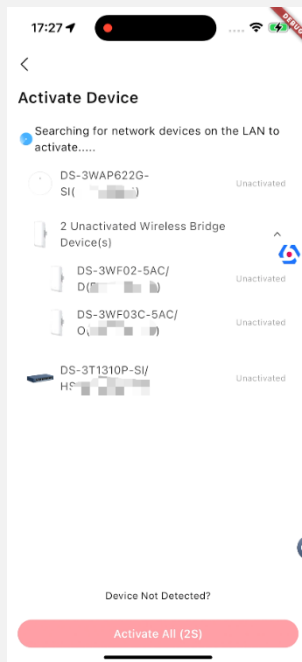
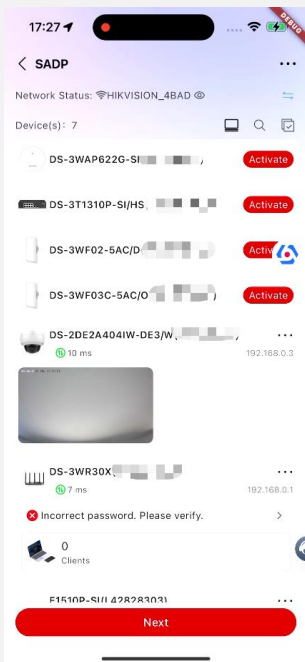

- Pairing

After activation, these wireless bridges need to be paired.

Click the "Pair" icon to choose the model working as "AP". Then choose models working as CPEs and set SSID, Pairing Password, Country/Region Code for pairing.

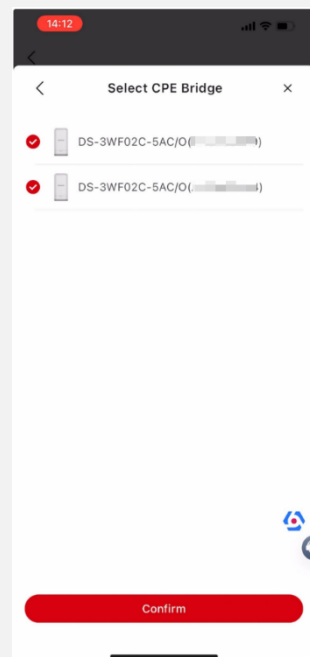
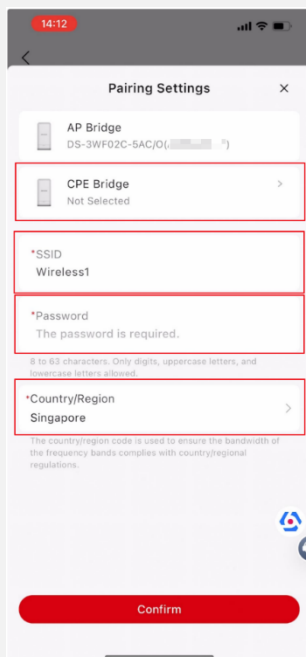
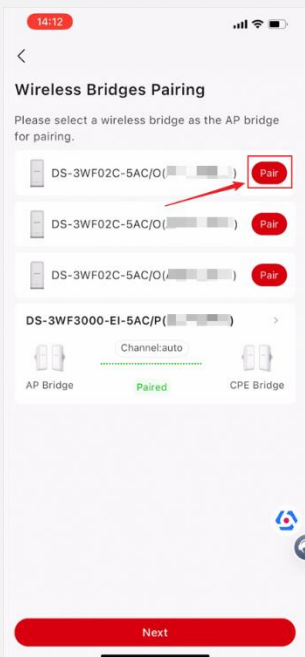

02 Product How to

How to Setup Wireless Bridge on Hik-Partner Pro

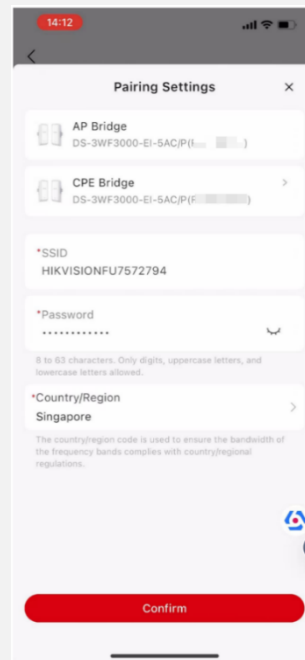
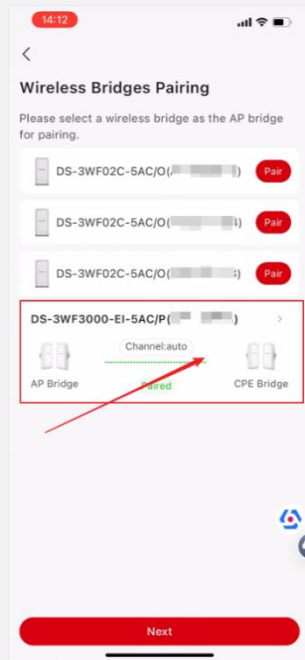

The wireless bridge kit will be paired automatically. Click the model to change settings if needed.

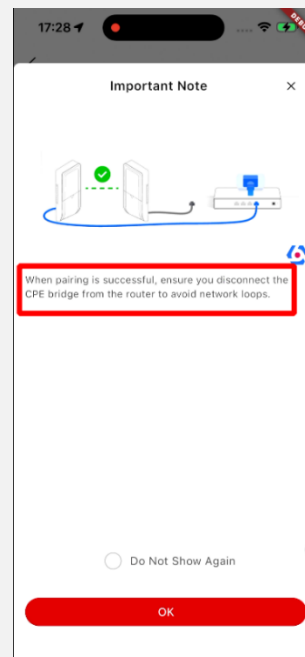

Note: Please disconnect the CPEs from the Router to avoid network loops after pairing.

02 Product How to

How to Setup Wireless Bridge on Hik-Partner Pro

- Add Device to Site

Add bridges to site after activation and pairing.

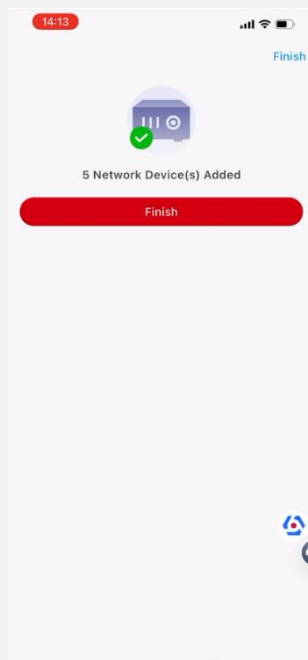
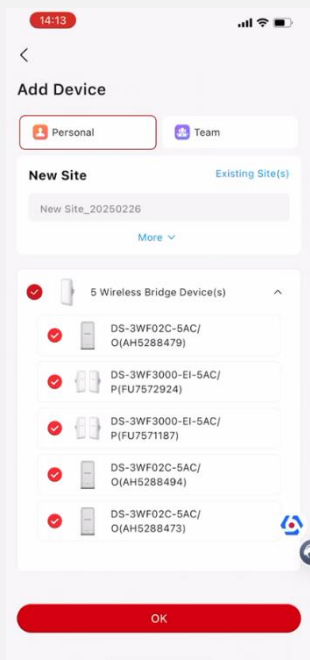

Topology & Connection Status

- Bridge Group Status

Click the device card to view the connection status of the bridge group, including signal intensity, background noise, sending/receiving rate

Slide the device pictures to view the connection status of different devices.

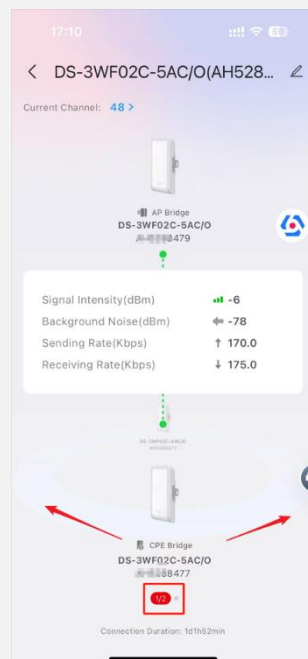
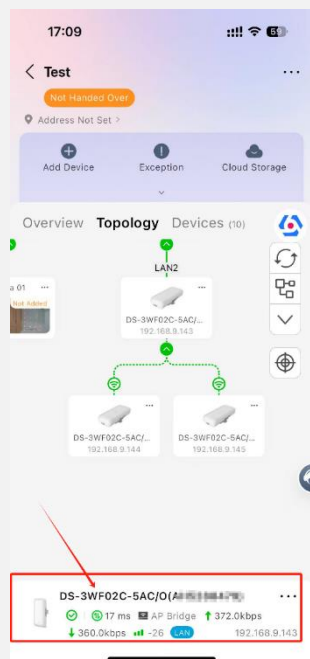

02 Product How to

How to Setup Wireless Bridge on Hik-Partner Pro

Click the device picture to check device status and configure.

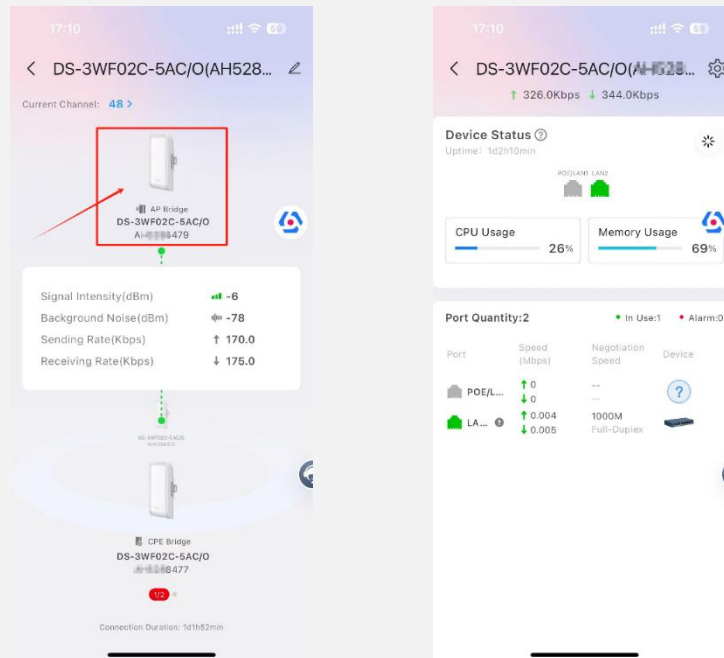

- Configuration

Wireless bridges support configurations on Hik-Partner Pro.

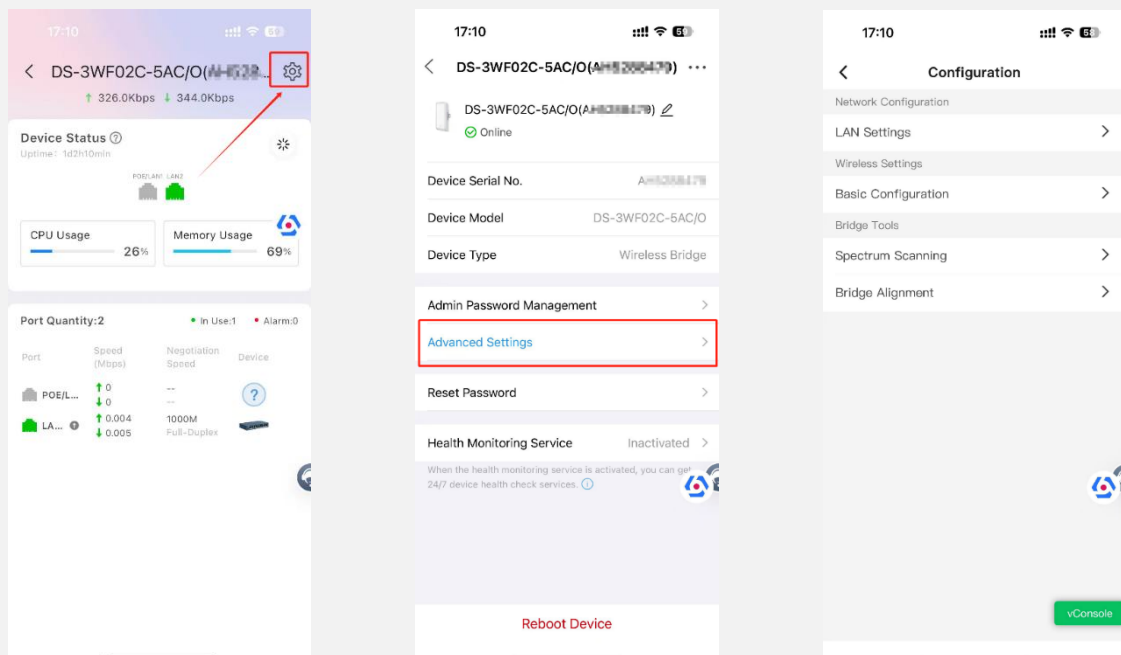

02 Product How to

How to Setup Wireless Bridge on Hik-Partner Pro

LAN Settings

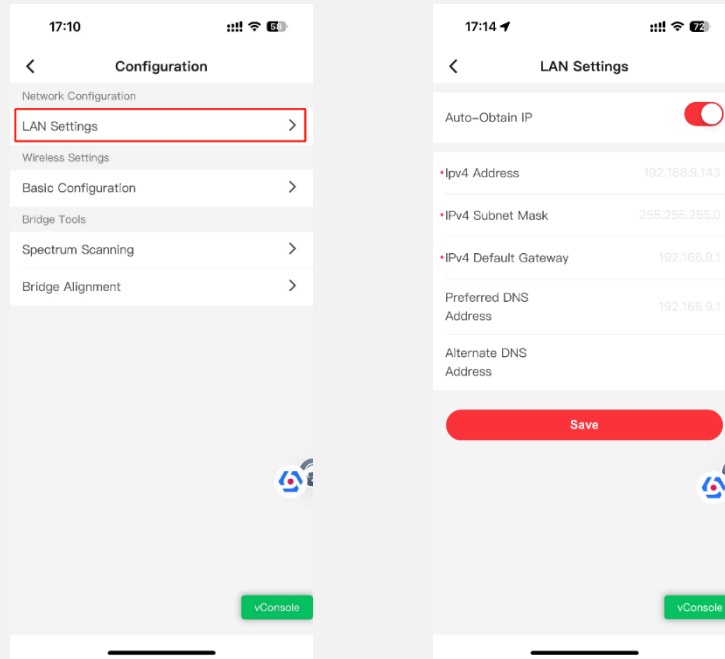

Wireless Settings/Basic Configuration

Hik-Partner Pro supports wireless configuration, including:

Work Scene: AP & CPE

SSID: Wi-Fi name

PSK Password: used for pairing, must be same in bridge groups

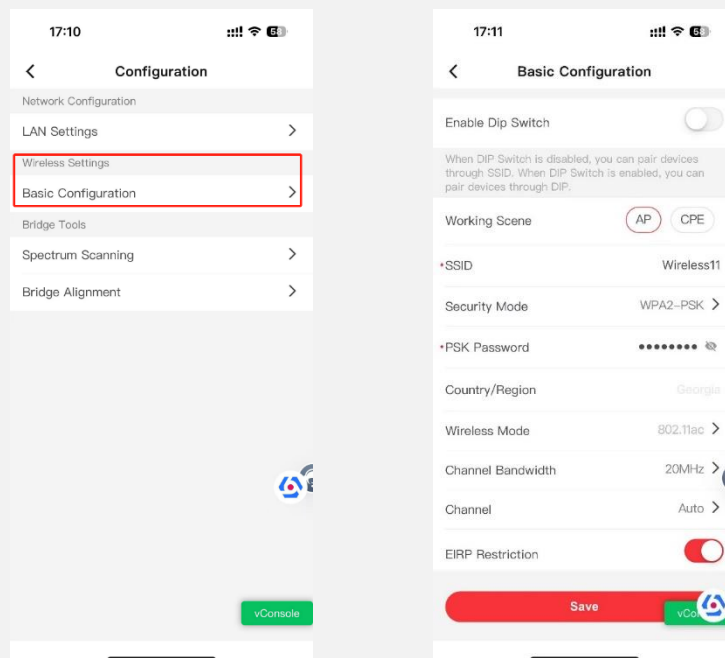

02 Product How to

How to Setup Wireless Bridge on Hik-Partner Pro

Channel Bandwidth & Channel (Only available on AP side).

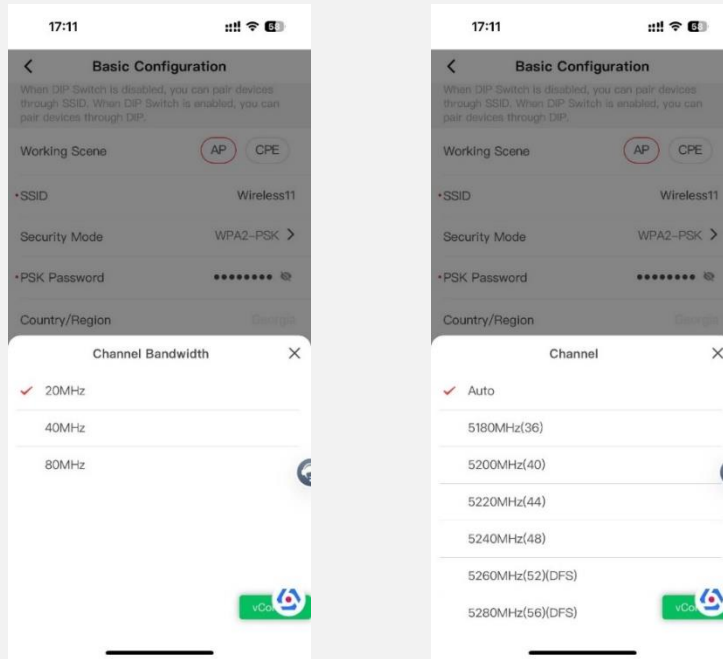

EIRP Restriction: adjust the transmit power after cancel this button. Please follow the local regulations while adjusting the transmit power.

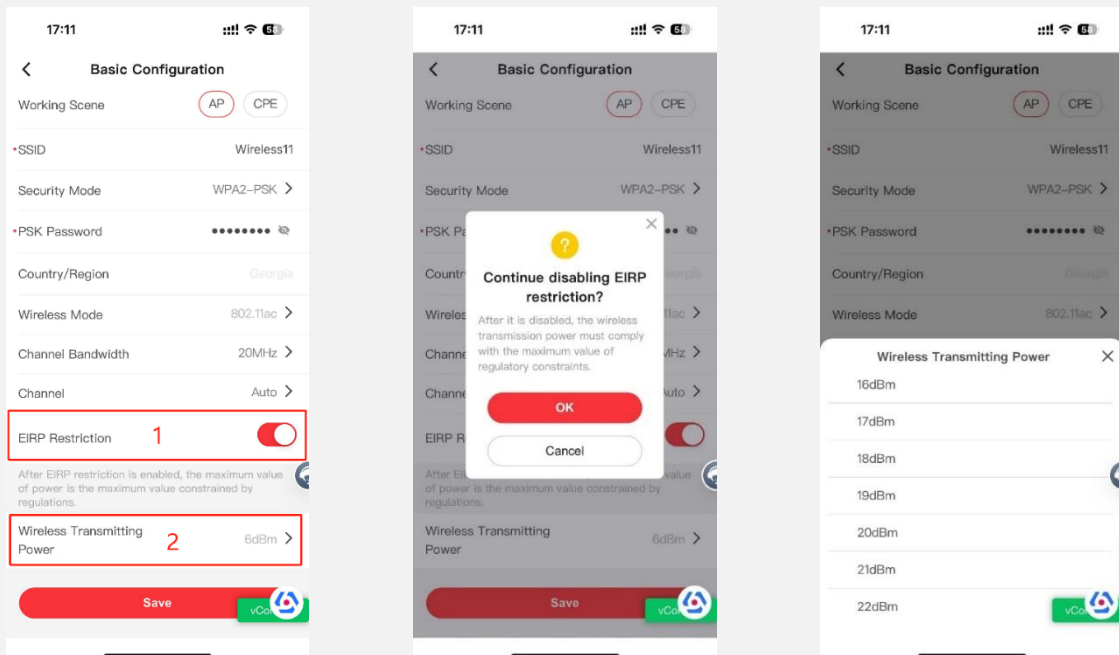

02 Product How to

How to Setup Wireless Bridge on Hik-Partner Pro

Spectrum Scanning

Spectrum Scanning helps to do the channel interference scan and give recommendations to reduce human errors in choosing the best channel.

Select the bandwidth (20/40/80MHz) to check scanning result.

Choose the channel and click "Switch Channel" to adjust the channel.

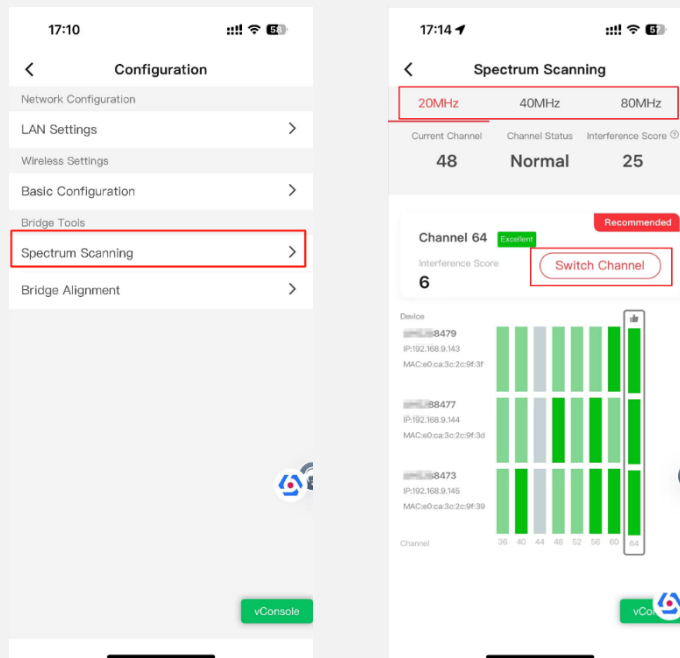

Note: This function is only available on AP side. CPE devices don't support.

Bridge Alignment

Bridge alignment can be used to measure changes of bridge signals in order to find the optimal signal location. Adjust the installation of the bridges according the signal intensity.

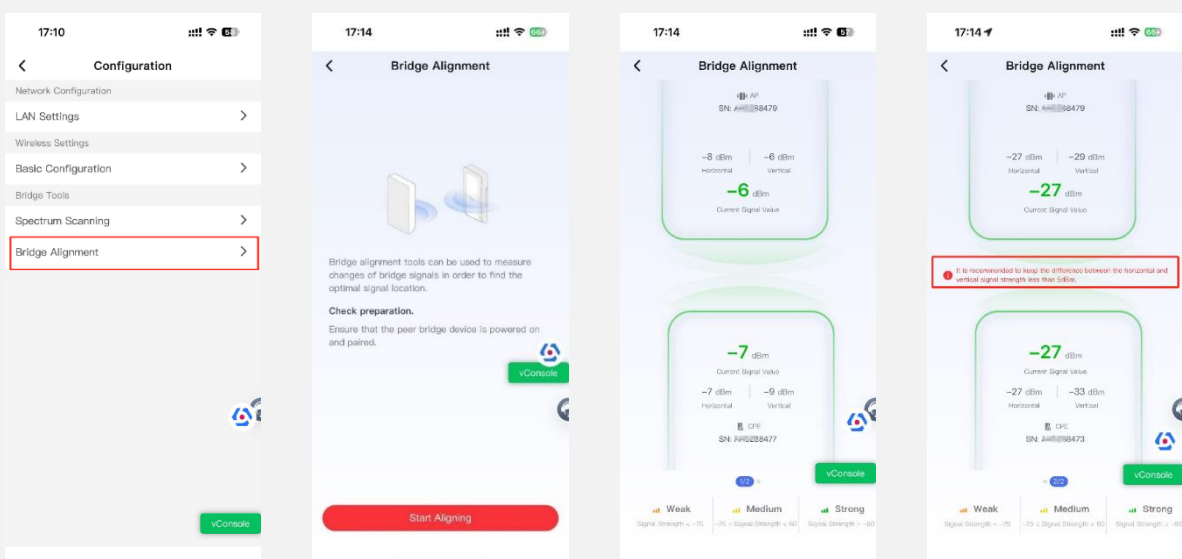

02 Product How to

How to Setup Wireless Bridge on Hik-Partner Pro

PoE Management

For models with standard PoE output (on the CPE side), Hik-Partner Pro supports PoE Management.

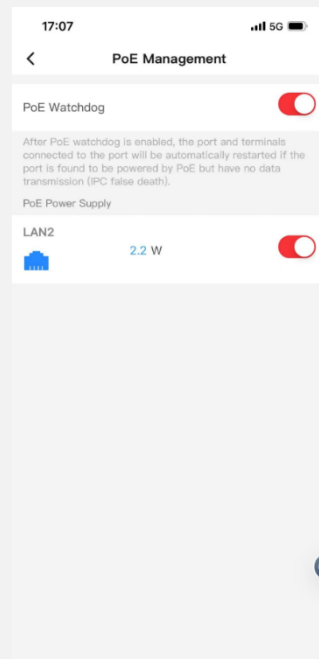
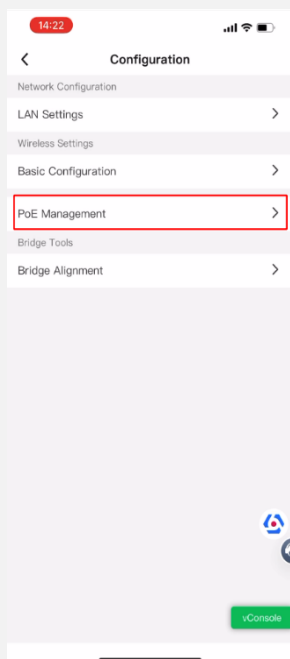

03 Product Q&A

Question 1 - What is the difference between Auto/Triggered by Video in Day Night Switching?

Answer:

According to the lighting threshold switching, the two modes have different thresholds.

Triggered enters the night earlier than Auto and switches back to the day later. Triggered is suitable for license plate scenes, and its advantage is to turn on the infrared lights earlier and turn them off later, ensuring that the license plate has as much fill light as possible and improving the capture rate.

Question 2 – Does the 4G module of the solar-powered camera support IPV6?

Answer:

not support.

Question 3 - What is the sticker material on the tamper-free packaging of 311328682 DS-2CD2687G3-LIZS2UY/SRB?

Answer:

102041053.



Question 4 - How does the anti banding function work?

Answer:

Control the minimum exposure time: P limit minimum 1/100 while N limit minimum 1/120.

Question 5 - Is there a matching black junction box for DS-1280ZJ-PT6?

Answer:

DS-1280ZJ-DM21(Black).

Question 6 - Do 2-series PTRZ cameras perform self-check upon reboot?

Answer:

No self-check occurs during web-based reboots or power-cycle reboots; Self-check is only triggered during initial activation or factory reset.

Question 7 - Why is the camera active when it's new out of the box?

Answer:

If there is an NVR on the same LAN, it may be activated by the NVR.

03 Product Q&A

Question 8 - Do we have a waterproof 12V power adapter?

Answer:

There is an old material that needs to be consulted about the inventory plan first. If there is, it can be activated to place an order.

304900541 DS-2PA1201-WRD (standard default).

Question 9 – What is the tail line of DS-2CD25G1-D/NF?

Answer:

It's reset button.

Question 10 - What information is metadata based on stream transmission? How does metadata transmit this information, directly overlay it onto the stream?

Answer:

Mainly the coordinates of the perimeter rule box and the target box. The coordinate information is transmitted to the client in the form of a message through the RTSP protocol. It is not directly embedded in the stream at the bottom of the device. The customer can directly obtain the coordinate data and then preview it for overlay.

04 Survey

An informative and inspiring newsletter needs your continual contributions and feedback, please feel free to submit your comments in this survey by clicking the link or scanning QR code: <https://www.surveymonkey.com/r/8GFLXDZ>

It will take you 2 minutes to complete. Thanks for your time in advance.

Hikvision Europe Monthly External Technical Newsletter Survey

